

PLAN NO 1829
 FOR THE IMPROVEMENT OF
'K' STREET
 BETWEEN
 SIXTEENTH STREET AND SEVENTEENTH STREET
 IN THE
 CITY OF SAN BERNARDINO
 CALIFORNIA

MARCH 1948

R.D. FORSYTHE
 Acting City Engineer

PLAN ADOPTED April 4, 1948

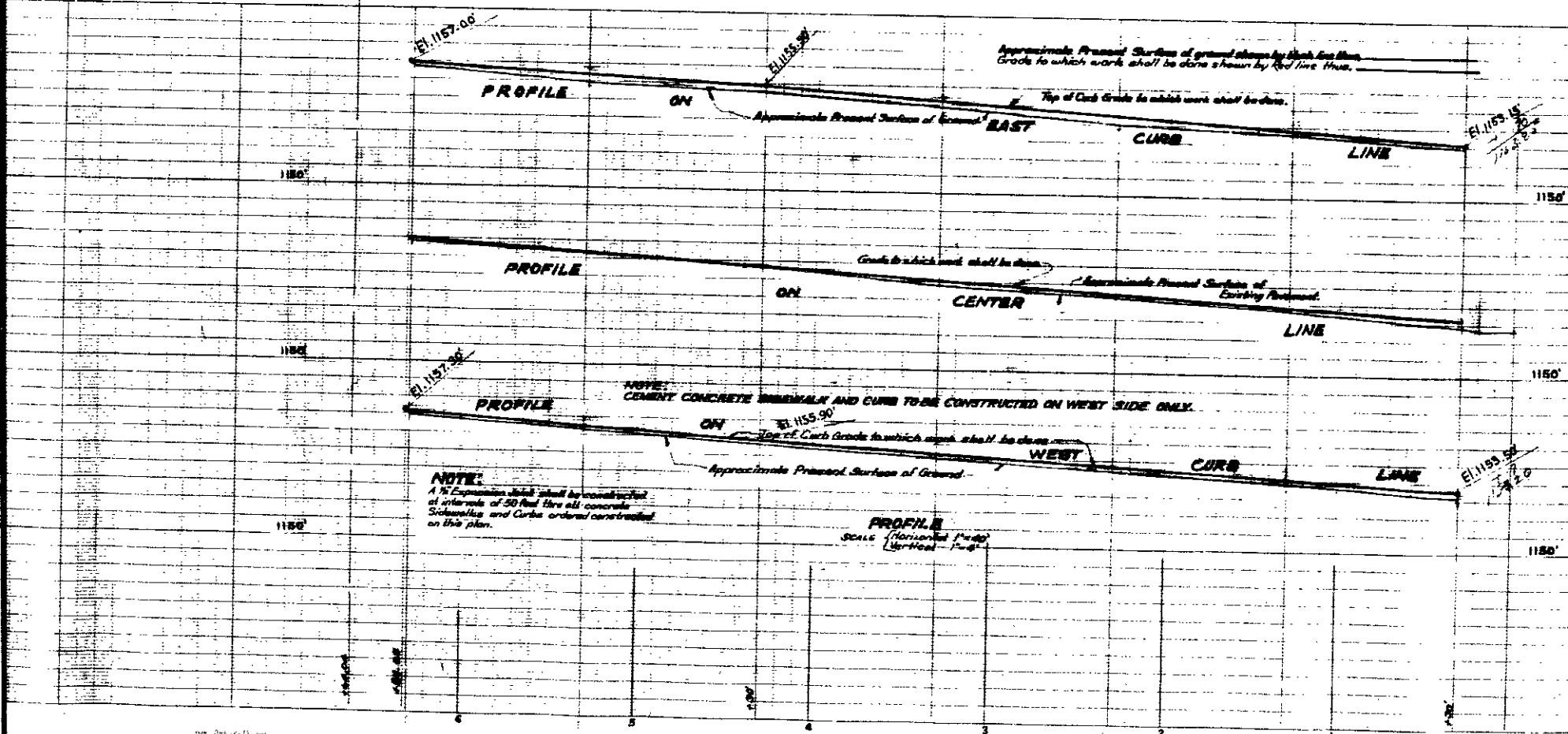
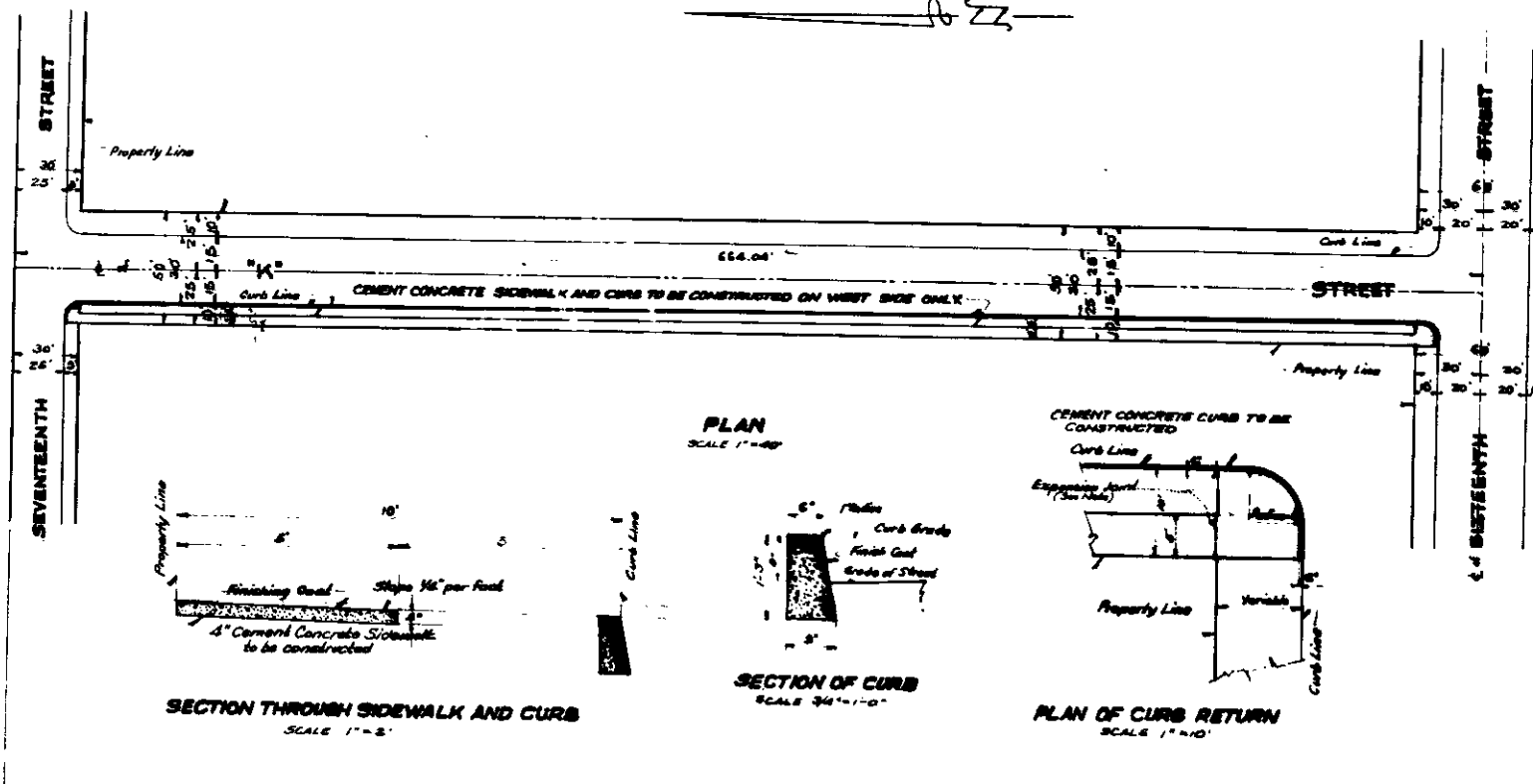

LEGEND
 or in means each or inches or 1/8 means 1/8 inch or feet.
 N# means Number.
 El means Elevation.
 C means Center Line.
 Cement Concrete Curb to be constructed shown thus: [Symbol]
 Cement Concrete Sidewalk to be constructed shown thus: [Symbol]

TITLE TO STREETS
 'K' STREET was dedicated by Sunshine Home Trust, as recorded in book 33 of maps, at page 17, records of San Bernardino County, California, Adopted.

GRADE ORDINANCE
 Grade of 'K' STREET was established by Resolution 19108 of the City of San Bernardino, California, Adopted October 21, 1923.

DATUM
 All elevations shown on this plan are in feet and are above a plane which is 1045.26 feet below the City Bench Mark, as established by Ordinance 14363 of the City of San Bernardino, California.

NOTE:
 A 1% Expansion Joint shall be constructed at intervals of 50 feet thru all concrete sidewalks and Curbs ordered constructed on this plan.